

Features

- For Base Station applications
- Usable bandwidth 60 MHz
- Low loss
- Single-ended operation
- Ceramic Surface Mount Package (SMP)
- Hermetic
- RoHS compliant (2002/95/EC), Pb-free 

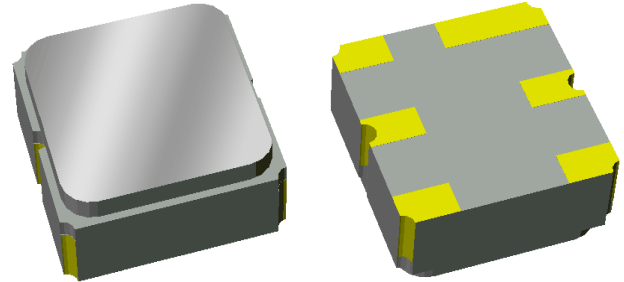

Package

Surface Mount 3.00 x 3.00 x 1.22 mm
SMP-12

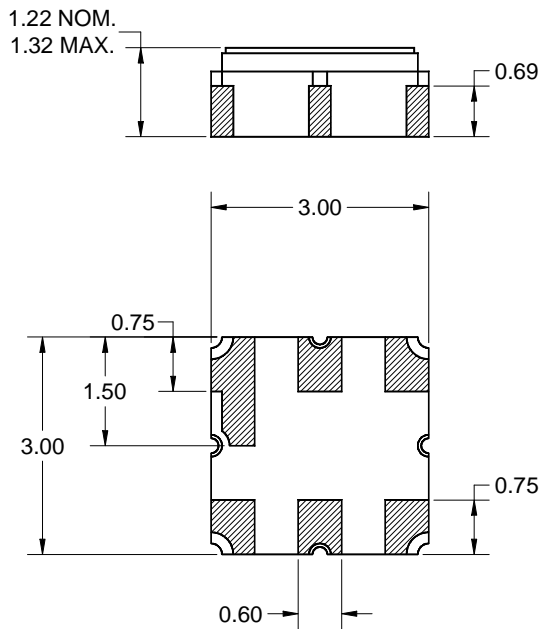

Pin Configuration

Bottom View

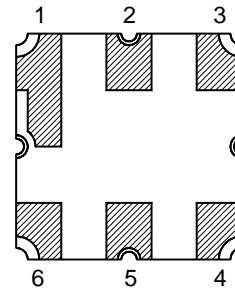

Pin No.	Description
2	Input
5	Output
1,3,4,6	Case Ground

Dimensions shown are nominal in millimeters
All tolerances are ± 0.15 mm except overall
length and width ± 0.10 mm

Body: Al_2O_3 ceramic
Lid: Kovar, Ni plated
Terminations: Au plating 0.5 - 1.0 μ m,
over a 2 - 6 μ m Ni plating

Electrical Specifications ⁽¹⁾

Specified Temperature Range: ⁽²⁾ -30 to +85 °C

Parameter ⁽³⁾	Minimum	Typical ⁽⁴⁾	Maximum	Unit
Center Frequency	-	1950	-	MHz
Maximum Insertion Loss	-	1.8	3	dB
Amplitude Variation 1920 – 1980 MHz	-	0.45	1.6	dB p-p
Amplitude Variation(over any 5MHz band) 1920 – 1980 MHz	-	0.25	0.8	dB p-p
Phase Ripple 1920 – 1980 MHz	-	16	30	deg
Absolute Delay 1920 – 1980 MHz	-	11	50	ns
Group Delay Variation 1920 – 1980 MHz	-	6	30	ns p-p
Relative Attenuation ⁽⁵⁾				
180 – 220 MHz	20	49	-	dB
1470 – 1500 MHz	35	44.5	-	dB
1500 – 1540 MHz	35	40.5	-	dB
1540 – 1570 MHz	35	42	-	dB
1570 – 1601 MHz	35	45.5	-	dB
1601 – 1670 MHz	17	42	-	dB
1814 – 1840 MHz	20	33	-	dB
1840 – 1878 MHz	15	35.5	-	dB
2025 – 2050 MHz	3	11.5	-	dB
2100 – 2170 MHz	20	28	-	dB
2490 – 3000 MHz	25	44	-	dB
3213 – 3755 MHz	25	51.5	-	dB
4925 – 5527 MHz	25	41.5	-	dB
Input/Output VSWR 1920 – 1980 MHz	-	1.5	2.5	-
Source Impedance (single-ended) ⁽⁶⁾	-	50	-	Ω
Load Impedance (single-ended) ⁽⁶⁾	-	50	-	Ω

Notes:

1. All specifications are based on the TriQuint test circuit shown on page 4
2. In production, devices will be tested at room temperature to a guardbanded specification to ensure electrical compliance over temperature
3. Electrical margin has been built into the design to account for the variations due to temperature drift and manufacturing tolerances
4. Typical values are based on average measurements at room temperature
5. Relative to minimum insertion loss
6. This is the optimum impedance in order to achieve the performance shown

Typical Performance (at room temperature)

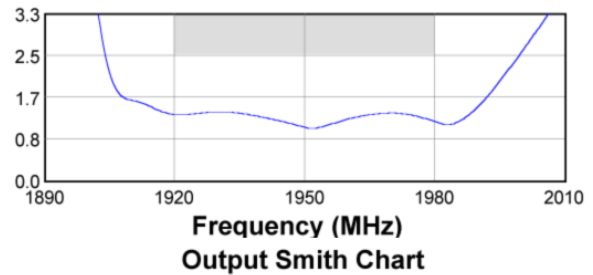
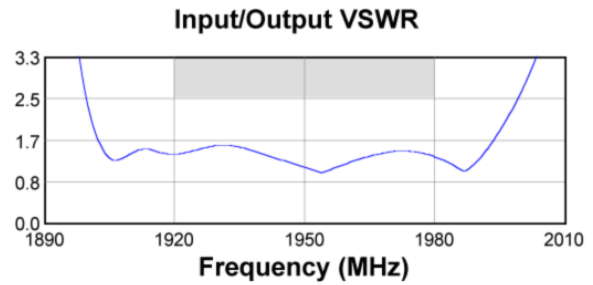
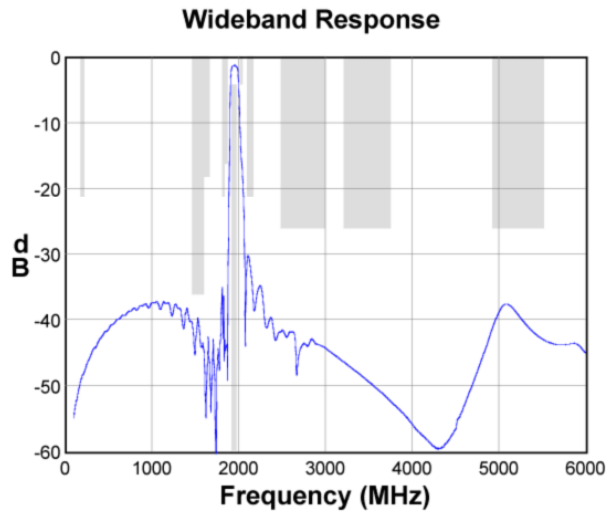
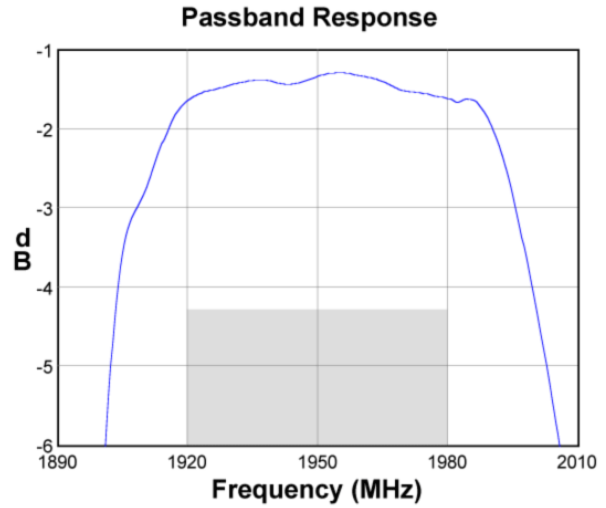
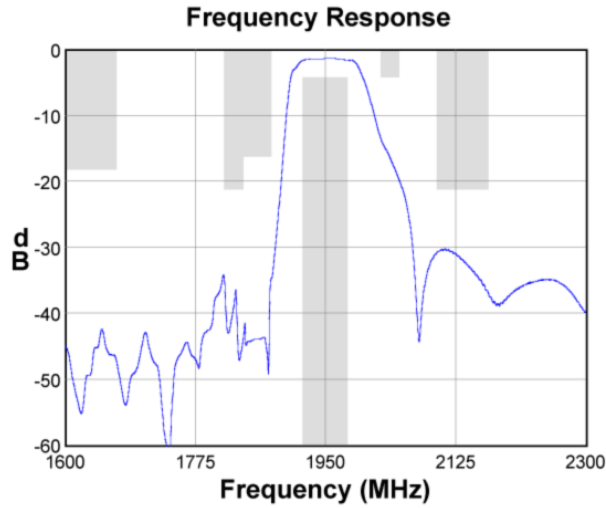

Input Smith Chart

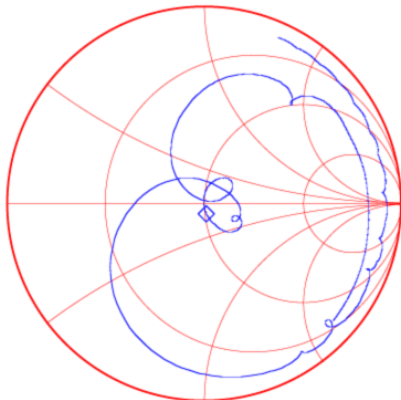

Matching Schematics

Actual matching values may vary due to PCB layout and parasitics

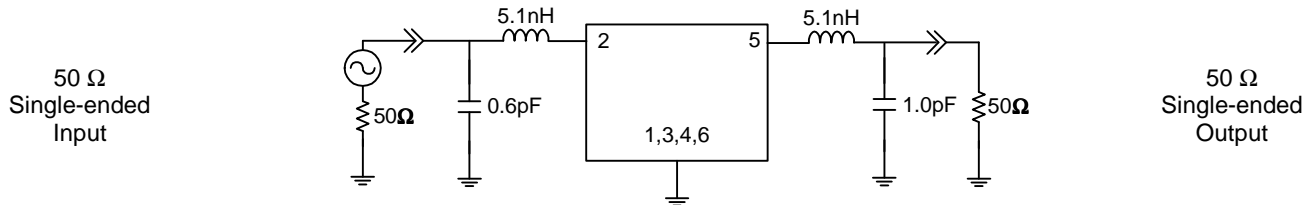

Marking

PCB Footprint

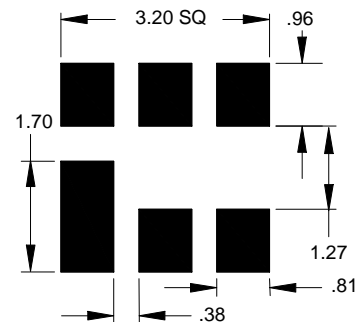
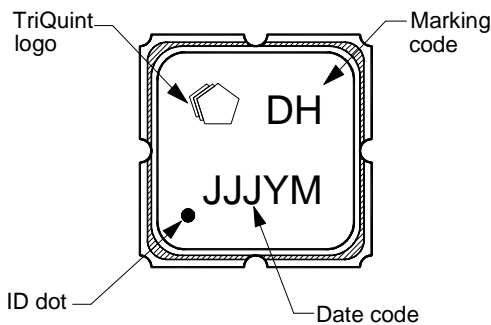

The date code consists of: day of the current year (Julian, 3 digits), last digit of the year (1 digit) M = manufacturing site code

This footprint represents a recommendation only
Dimensions shown are nominal in millimeters

Tape and Reel

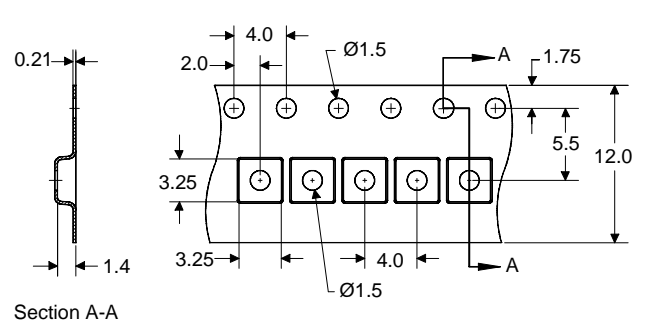
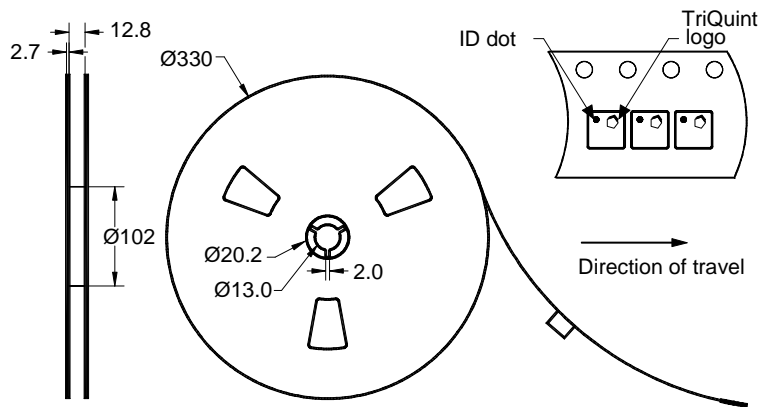

Dimensions shown are nominal in millimeters
Packaging quantity: 5000 units/reel

Maximum Ratings

Parameter	Symbol	Minimum	Maximum	Unit
Operating Temperature Range	T	-30	+85	°C
Storage Temperature Range	T _{stg}	-40	+85	°C
DC voltage on any port (instantaneous only)	-	-	+5	V
Input Power ⁽¹⁾	P _{in}	-	+22	dBm

Note:

1. Input Power is targeted for an applied CW modulated RF signal at 55 °C for 125 hours

Important Notes

Warnings

- Electrostatic Sensitive Device (ESD) 
- Avoid ultrasonic exposure

RoHS Compliance

- This product complies with EU directive 2002/95/EC (RoHS) 

Solderability

- Compatible with JESD22-B102, Pb-free process, 260C peak reflow temperature ([see soldering profile](#))

Links to Additional Technical Information

[PCB Layout Tips](#)

[Qualification Flowchart](#)

[Soldering Profile](#)

[S-Parameters](#)

[RoHS Information](#)

[Other Technical Information](#)

TriQuint's liability is limited only to the Surface Acoustic Wave (SAW) component(s) described in this data sheet. TriQuint does not accept any liability for applications, processes, circuits or assemblies, which are implemented using any TriQuint component described in this data sheet.

Contact Information



PO Box 609501
Orlando, FL 32860-9501
USA

Phone: +1 (407) 886-8860
Fax: +1 (407) 886-7061
Email: info-product@tqs.com
Web: www.triquint.com

Or contact one of our worldwide
Network of [sales offices](#),
[Representatives or distributors](#)